

Clifford Retail Center
 Fort Worth, Texas 76108



➤ **Two pad sites available for restaurant/retail use**

➤ **Excellent visibility from Interstate Loop 820**

➤ **Private interior driveway (Clifford Center Drive) & cross access across all lots provides easy accessibility for customers**

➤ **Ground Lease or Build-to Suite**



For Information:

(817) 731-6199 Phone
 (817) 731-0899 Fax

Hickman Investments, Ltd.

6777 Camp Bowie Blvd., Ste. 600
 Fort Worth, Texas 76116



Clifford Retail Center Fort Worth, Texas 76108

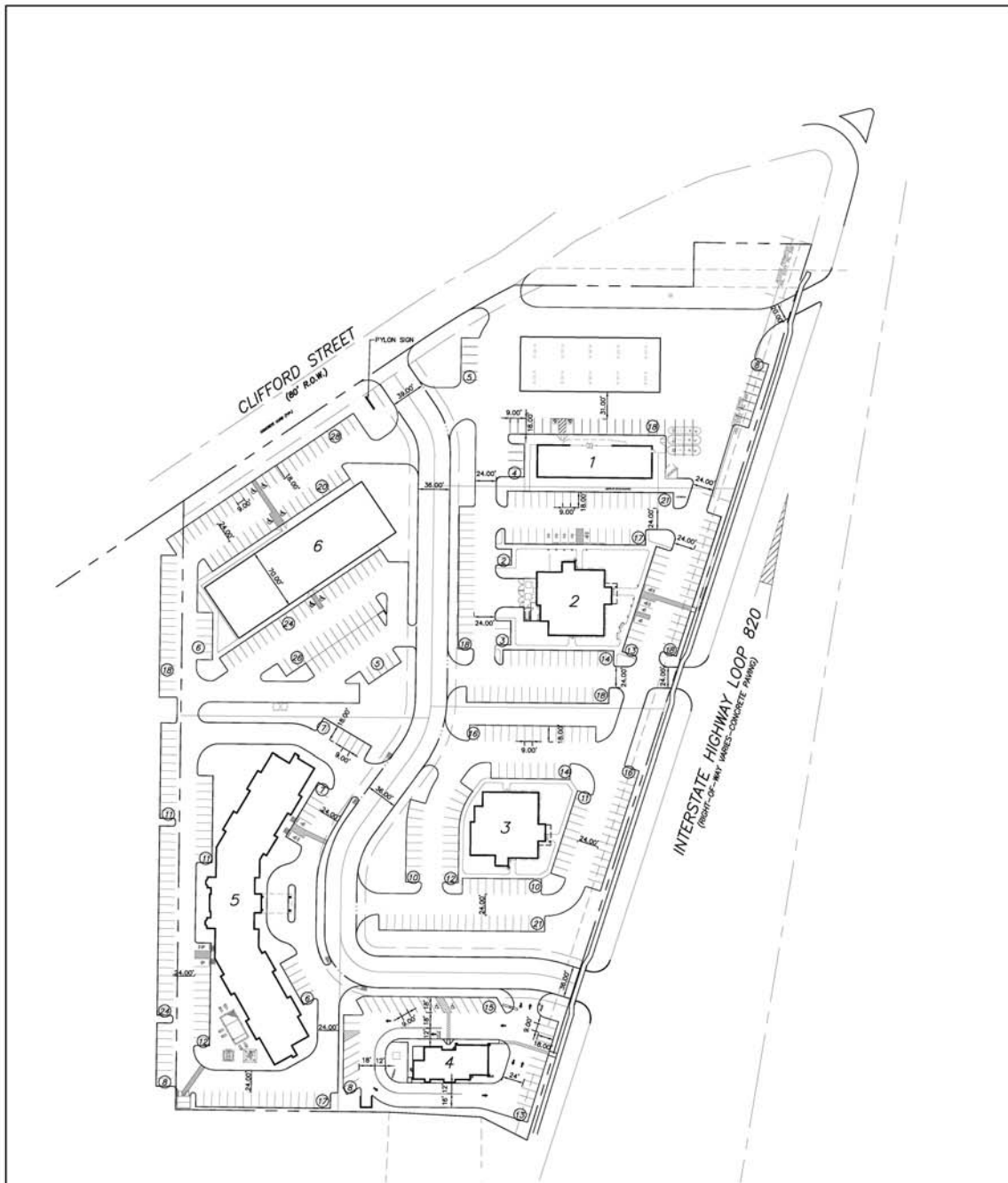

SITE DATA TABLE

TRACT	ACREAGE	USE	BLDG. S.F.	PARKING
1	2.10	QUIKTRIP	4,903	35
2	1.76	CHILI'S	6,600	124
3	2.00	RESTAURANT	6,600	110
4	0.94	FAST FOOD	3,062	36
5	2.10	STAYBRIDGE SUITES (85 RMS)	56,500	103
6	2.08	RETAIL	15,000	126
TOTAL	10.98		92,665	534



Scale: AS SHOWN
 Designed by:
 Drawn by:
 Checked by:
 Date: OCTOBER 2008
 Project No.

SITE PLAN 'G'

HICKMAN INVESTMENTS
CLIFFORD RETAIL CENTER
FORT WORTH, TEXAS

Kimley-Horn
and Associates, Inc.
800 County Street, Suite 111, Suite 900
Fort Worth, Texas 76102
Tel No. (817) 335-8811
Fax No. (817) 335-5070

Clifford Retail Center

Fort Worth, Texas 76108

